

The Ark logo is displayed in a bold, blue, sans-serif font. The letter 'A' is significantly larger than the other letters, and the 'r' and 'k' are connected. The logo is positioned in the upper left quadrant of the image, overlaid on a semi-transparent white rectangular area.

Ark

Since the foundation of the first subsidiary in Hong Kong in 2005, Ark Prefab has become the leading supplier of prefabricated buildings and contractor of modular building construction.

Ark now owns 3 subsidiaries across China Mainland and Hong Kong, including Ark China Company Ltd., Ark Modular Building Manufacturing Company Ltd., and RISENSUN (HK) Company Ltd.

why ARK PODS ?

SPEED



Factory operations are up to **250%** more efficient than the same activity carried out on-site.

● SPEED

This is the big differentiator where finishing the bathrooms is traditionally on the critical path for completion. An 80-room hotel fits this where a 100,000-square foot warehouse with a single bathroom may not. ARK will be producing and finishing a bathroom while the dirt is still being moved on-site. With properly routed and bundled utilities, the units can be very quickly connected into the larger building with a lower level of skill required.

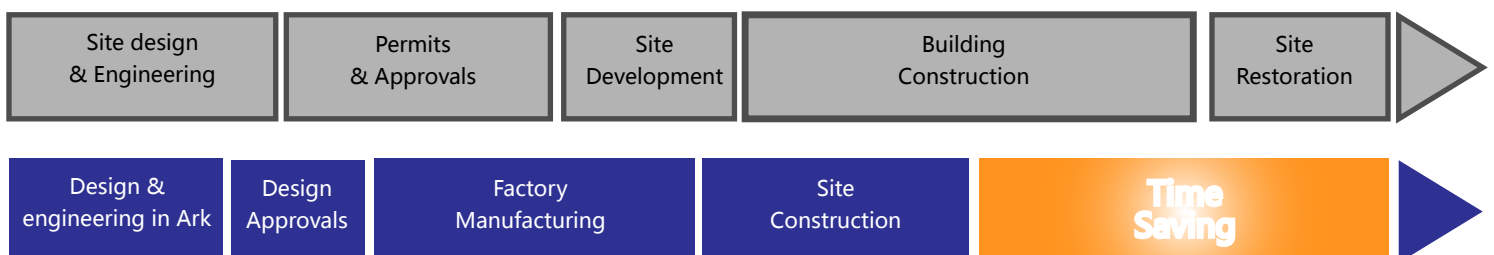

OVERHEAD SAVINGS



\$27M

Additional revenue earned by the hospital due to the use of bathroom pods and the ability to open 3 months ahead of schedule

104

Bathroom Pods produced

● OVERHEAD SAVINGS

Cost effectiveness was extremely important due to the goal set forth by the client. Historically, prefabrication is most cost effective when there are a large number of units.

ARK has proven that it can cut 3 months off of a 100 bed hospital construction project, with no increase in costs. The average revenue per bed for these facilities is \$3,000 per day. A 100 bed facility generates \$300,000 in revenue per day, or \$9 million a month. By implementing modular components and opening 3 months sooner, the hospital earned an additional \$27 million in revenue. Modular innovation is creating real value for clients and driving an outstanding return on investment.

QUALITY CONTROL



● QUALITY CONTROL

- Automation drives dimensional accuracy
- Incoming material inspection process
- Quality control at every station
- Final 120-point quality assurance inspection
- Controlled, well lit work environment
- Integrated CAD / CAM system drives BIM model straight into production
- Stable, permanent employees cross-trained in multiple functions



how **ARK PODS** works ?

WORKING PROCESS

DESIGN



1 ARK Pods are modeled in Revit by our engineers which facilitates the use of BIM or building information modeling.

PRODUCTION



2 The ARK factory is driven by automation. Materials are cut using CNC machines which drive dimensional accuracy.

INSTALLATION



4 The ARK factory is driven by automation. Materials are cut using CNC machines which drive dimensional accuracy.

DELIVERY

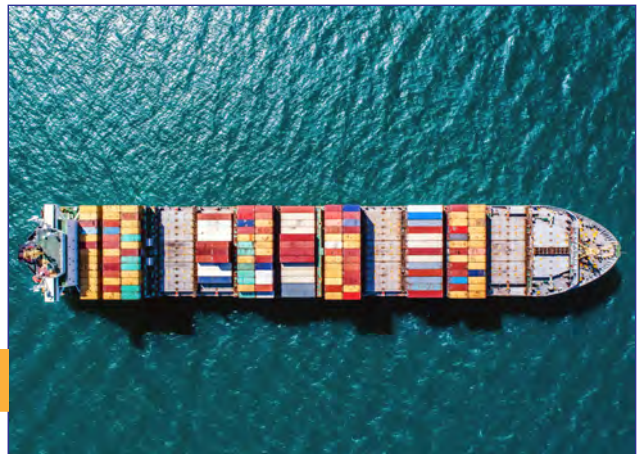

3 Bathroom pods are primarily shipped to project sites overseas in shipping containers

WORKING PROCESS

CONNECTIONS

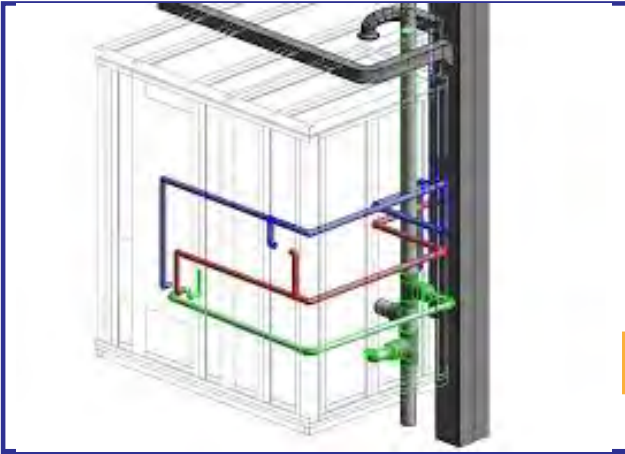

5 Contractors connect the bathroom pod to the buildings services. Early planning of scope helps contractors know where the pod systems will connect.

HAND OFF



6 Customer and a ARK representative do a walk-through inspection of all bathroom units once on site. When hand-off is complete, the warranty period begins.

FINISHING

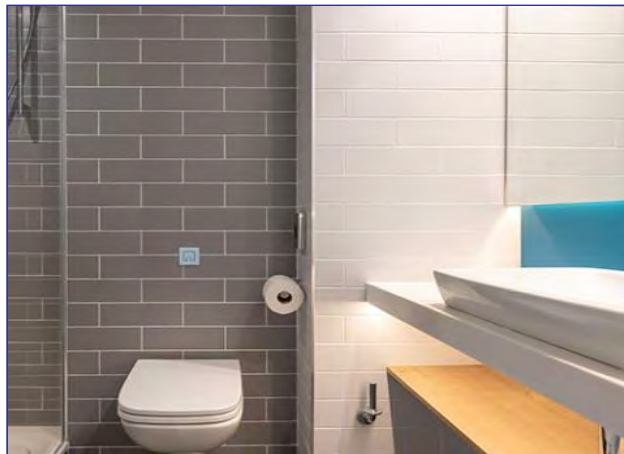

7 The bathrooms are complete. You now have superior quality bathrooms ready for occupancy. ARK stands behind our bathroom pods 100%.

SPECIFICATION

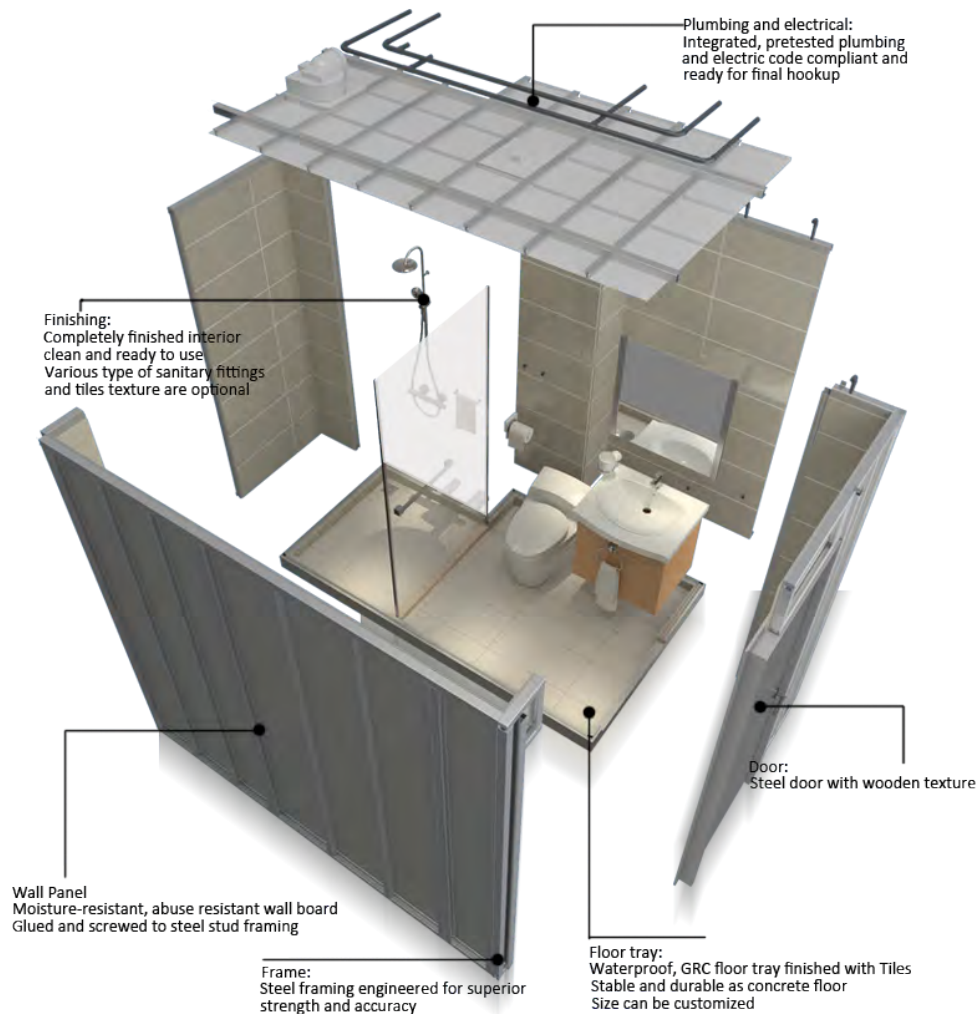

Product introduction

Ark Pods use light steel stud as frame and GRC floor tray, this system engineered for superior strength and accuracy.

All plumbing and electrical will be integrated and pretested code compliant and ready for hookup.

Internal finished by Tiles or paintings, various textures and colors of tiles/painting are available as per clients requirements.

Ark have common POD models as well as special designed for different projects, according to the site research and client requests

ACCESSORIES

Accessories meeting various requirements from different regions and countries around the globe are available from Ark, such as certificates for SAA , WaterMark. PSE,CSA,SABS,CE and UL



ARK PREFAB

Head Office

RM.701,Block A,No.581 Xiuchuan Road,Shanghai,PRC | 201299

T:0086(0)2160838082 | F: 0086(0)2160838081 | E: sophie@arkprefab.com

www.arkprefab.com